

Quick Start Guide

Table of Contents

Qualified Persons	2	Software	6
Read this Instruction Sheet	2	Downloading Software	6
Retain this Instruction Sheet	2	Installing Software	6
Proper Application	2	Launching Software	6
Warranty	2	Downloading Full Instruction Sheet 461-504	6
Understanding Safety-Alert Messages.	3	Connecting to a TripSaver II Recloser	7
Following Safety Instructions	3	Appendix A	13
Replacement Instructions and Labels	3	Regulatory and Compliance Statements:	13
Safety Precautions	4		
Hardware	5		
Contents of Configuration Kit	5		

★ Catalog Number 5950R2



Introduction

Qualified Persons

WARNING

The equipment covered by this publication must be installed, operated, and maintained by qualified persons who are knowledgeable in the installation, operation, and maintenance of primary distribution fusing equipment along with associated hazards. A qualified person is one who is trained and competent in:

- The skills and techniques necessary to distinguish exposed live parts from nonlive parts of electrical equipment
- The skills and techniques necessary to determine the proper approach distances corresponding to the voltages to which the qualified person will be exposed
- The proper use of the special precautionary techniques, personal protective equipment, insulating and shielding materials, and insulated tools for working on or near exposed energized parts of electrical equipment

These instructions are intended only for such qualified persons. They are not intended to be a substitute for adequate training and experience in safety procedures for this type of equipment.

Read this Instruction Sheet

NOTICE

Thoroughly and carefully read this instruction sheet before installing or operating the TripSaver II Cutout-Mounted Recloser. The latest version is available online in PDF format at sandc.com/en/support/product-literature/.

Become familiar with Safety Information and Safety Precautions on pages 3 and 4.

Retain this Instruction Sheet

This instruction sheet should be available for reference wherever TripSaver II Cutout-Mounted Reclosers are used. Retain this instruction sheet in a location where users can easily retrieve and refer to it.

Proper Application

WARNING

The TripSaver II Cutout-Mounted Recloser must only be used for a specific protection application that is within the ratings of the model selected. Ratings for the TripSaver II Cutout-Mounted Recloser can be found in Specification Bulletin 461-33. TripSaver II recloser ratings also are laser-etched on the recloser.

Warranty

The warranty and/or obligations described in S&C's standard conditions of sale, as set forth in Price Sheet 150, plus any special warranty provisions, as set forth in the applicable product-line specification bulletin, are exclusive. The remedies provided in the former for breach of these warranties shall constitute the immediate purchaser's or end user's exclusive remedy and a fulfillment of all the seller's liability. In no event shall the seller's liability to the immediate purchaser or end user exceed the price of the specific product that gives rise to the immediate purchaser's or end user's claim. All other warranties, whether express or implied or arising by operation of law, course of dealing, usage of trade or otherwise, are excluded. The only warranties are those stated in Price Sheet 150, and THERE ARE NO EXPRESS OR IMPLIED WARRANTIES OF MERCHANTABILITY OR FITNESS FOR A PARTICULAR PURPOSE. ANY EXPRESS WARRANTY OR OTHER OBLIGATION PROVIDED IN PRICE SHEET 150 IS GRANTED ONLY TO THE IMMEDIATE PURCHASER AND END USER, AS DEFINED THEREIN. OTHER THAN AN END USER, NO REMOTE PURCHASER MAY RELY ON ANY AFFIRMATION OF FACT OR PROMISE THAT RELATES TO THE GOODS DESCRIBED HEREIN, ANY DESCRIPTION THAT RELATES TO THE GOODS, OR ANY REMEDIAL PROMISE INCLUDED IN PRICE SHEET 150.

Understanding Safety-Alert Messages

Several types of safety-alert messages may appear throughout this instruction sheet and on labels attached to the crate, packing, and equipment. Become familiar with these types of messages and the importance of these various signal words:

⚠ DANGER

“DANGER” identifies the most serious and immediate hazards that will likely result in serious personal injury or death if instructions, including recommended precautions, are not followed.

⚠ WARNING

“WARNING” identifies hazards or unsafe practices that can result in serious personal injury or death if instructions, including recommended precautions, are not followed.

⚠ CAUTION

“CAUTION” identifies hazards or unsafe practices that can result in minor personal injury if instructions, including recommended precautions, are not followed.

NOTICE

“NOTICE” identifies important procedures or requirements that can result in product or property damage if instructions are not followed.

Following Safety Instructions

If any portion of this instruction sheet is unclear and assistance is required, contact the nearest S&C Sales Office or S&C Authorized Distributor. Their telephone numbers are listed on S&C’s website sandc.com, or call the S&C Global Support and Monitoring Center at 1-888-762-1100.

NOTICE

Read this instruction sheet thoroughly and carefully before installing or operating the TripSaver II Cutout-Mounted Recloser.

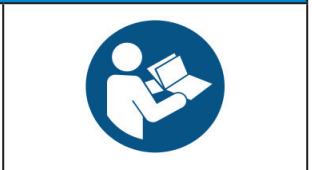

Replacement Instructions and Labels

If additional copies of this instruction sheet are needed, contact the nearest S&C Sales Office, S&C Authorized Distributor, S&C Headquarters, or S&C Electric Canada Ltd.

It is important that any missing, damaged, or faded labels on the equipment be replaced immediately. Replacement labels are available by contacting the nearest S&C Sales Office, S&C Authorized Distributor, S&C Headquarters, or S&C Electric Canada Ltd.

⚠ DANGER



The TripSaver II Cutout-Mounted Recloser operates at high voltage. Failure to observe these precautions will result in serious personal injury or death.

Some of these precautions may differ from your company's operating procedures and rules. Where a discrepancy exists, follow your company's operating procedures and rules.

1. **QUALIFIED PERSONS.** Access to TripSaver II Cutout-Mounted Reclosers must be restricted only to qualified persons. See the "Qualified Persons" section on page 2.
2. **SAFETY PROCEDURES.** Always follow safe operating procedures and rules.
3. **PERSONAL PROTECTIVE EQUIPMENT.** Always use suitable protective equipment, such as rubber gloves, rubber mats, hard hats, safety glasses, and flash clothing, in accordance with safe operating procedures and rules.
4. **SAFETY LABELS AND TAGS.** Do not remove or obscure any of the "DANGER," "WARNING," "CAUTION," or "NOTICE" labels and tags. Remove tags ONLY if instructed to do so.
5. **ENERGIZED COMPONENTS.** Always consider all parts live until de-energized, tested, and grounded.
6. **OPERATING TOOLS.** To close a TripSaver II Cutout-Mounted Recloser, use a conventional insulated hotstick or S&C Universal Pole and Pole Extension fitted with a Talon™ Handling Tool or distribution prong. An extendostick also can be used after proper training and practice. The TripSaver II Cutout-Mounted Recloser can be opened using Loadbuster®—The S&C Loadbreak Tool attached to a conventional insulated hotstick or S&C Universal Pole.
7. **MAINTAINING PROPER CLEARANCE.** Always maintain the proper clearance from energized components.

⚠ WARNING

DO NOT disassemble a TripSaver II recloser. The control module inside the TripSaver II recloser housing is only intended for use inside the TripSaver II recloser and has not been approved for any other use. There are no customer-serviceable parts inside the recloser, and disassembling the recloser voids the warranty. If you do disassemble a TripSaver II recloser, NEVER power it with the power module included with the Service Center Configuration Kit when the inside of the recloser is exposed. Unsafe high voltage can be present on the connectors on the outside of the internal control box assembly, resulting in serious injury or death.

⚠ WARNING

The TripSaver II Cutout-Mounted Recloser MUST be de-energized and removed from the utility pole before attaching the "corded" power module (power module with ac adapter and extension cord) to the base of the TripSaver II recloser. The corded power module is ONLY intended to be used for set-up and data collection when the TripSaver II recloser is de-energized and removed from the utility pole. (To provide power to a TripSaver II recloser while it is mounted to the pole, use the cordless power module, S&C catalog number 5954.) Failure to remove the TripSaver II recloser from the utility pole before connecting the corded power module may cause arcing, burns, electric shock, and death.

Contents of Configuration Kit

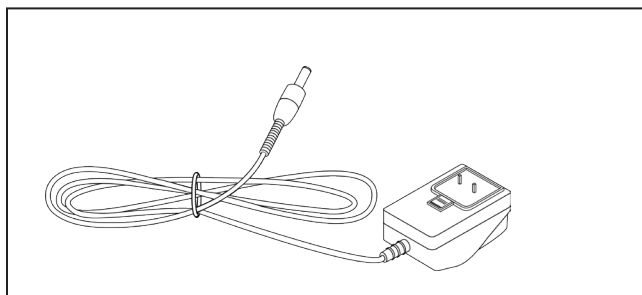

Ac adapter

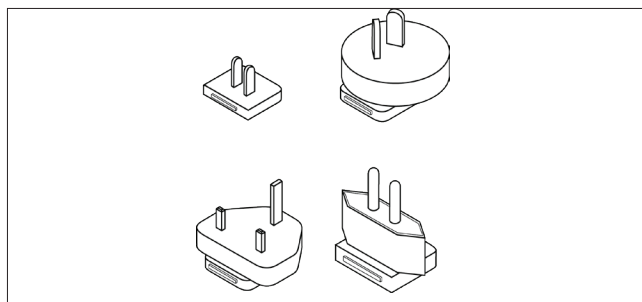

Power outlet plug adapters

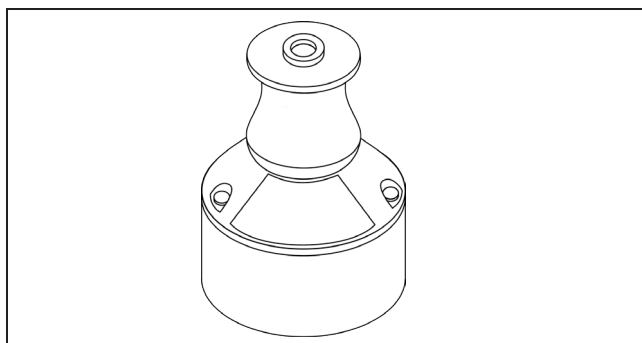

TripSaver II Power Module

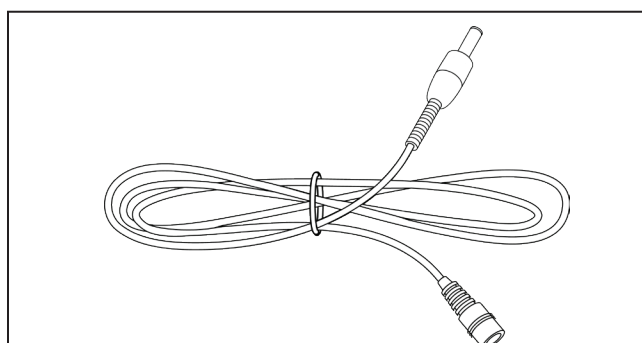

Extension cord for ac adapter

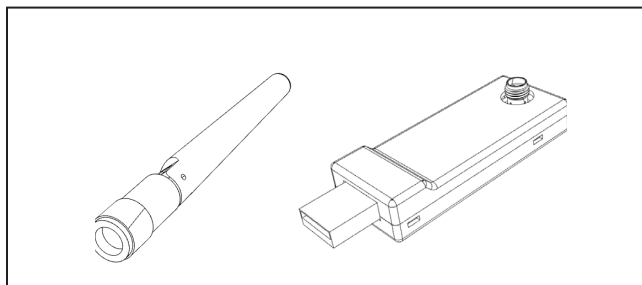

USB transceiver and antenna

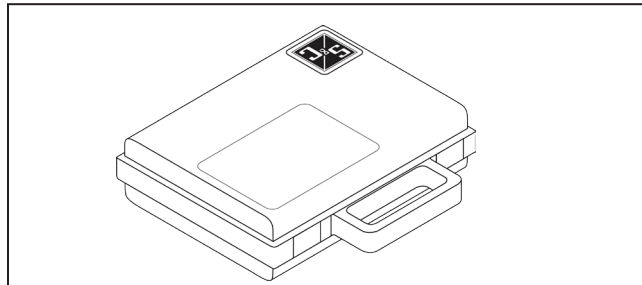

Carrying case

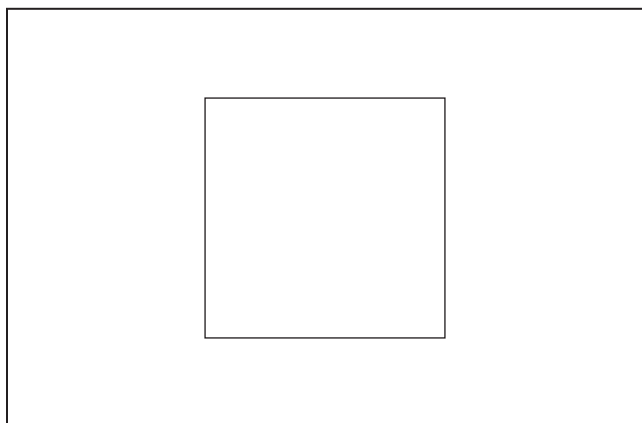

Blank adhesive labels (transparent overlay also included) for writing user-configuration parameters. To be attached to the left side of the lower TripSaver II recloser housing

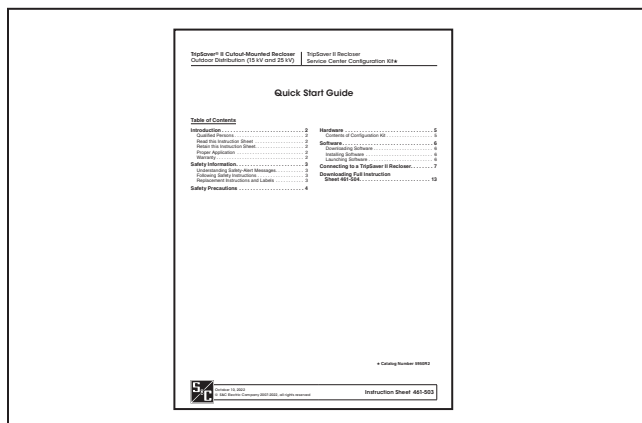

This Quick Start Guide

Downloading Software

TripSaver® II Service Center Configuration Software v2.1 is available for download only to customers who have purchased the configuration kit. The latest software release is posted on the S&C Automation Customer Support Portal at sandc.com/en/contact-us/sc-customer-portal/. The user will need a username and password to log in to the portal. New customers must complete the form in the lower section of the webpage. When the form is completed, S&C will send the user a new username and password. Users who already have a password can click on the **Log in to the Secure Site** button. Enter a username and password to log in to the portal. Download the SCCv2.1 Installer from the portal.

Installing Software

Double-click on the downloaded installer file and follow the on-screen instructions. The installer will automatically install Microsoft .NET framework onto the computer if the required .NET version is missing. Users require administrative privileges to finish the installation.

Launching Software

To launch the software, click on the green **SCC 2.1** icon on the desktop or in the **Start** menu. A warning screen will be displayed right after the software is launched. Read the message carefully and understand the warning. Proceed by clicking on the green **I have read and understand the above warning** button.

Downloading Full Instruction Sheet 461-504

For more information on the TripSaver II Cutout-Mounted Recloser Service Center Configuration Software, download Instruction Sheet 461-504 at: sandc.com/461-504

⚠ WARNING

The TripSaver II Cutout-Mounted Recloser **MUST** be de-energized and removed from the utility pole before attaching the “corded” power module (power module with ac adapter and extension cord) to the base of the TripSaver II recloser. The corded power module is **ONLY** intended to be used for setup and data collection when the TripSaver II recloser is de-energized and removed from the utility pole. (To provide power to a TripSaver II recloser while it is mounted to the pole, use the cordless power module, S&C catalog number 5954.) Failure to remove the TripSaver II recloser from the utility pole before connecting the corded power module can cause arcing, burns, electric shock, and death.

Follow these steps to connect to a TripSaver II recloser to apply new settings:

- STEP 1.** Screw the threaded bottom of the antenna into the threaded connector on the USB transceiver. See Figure 1.

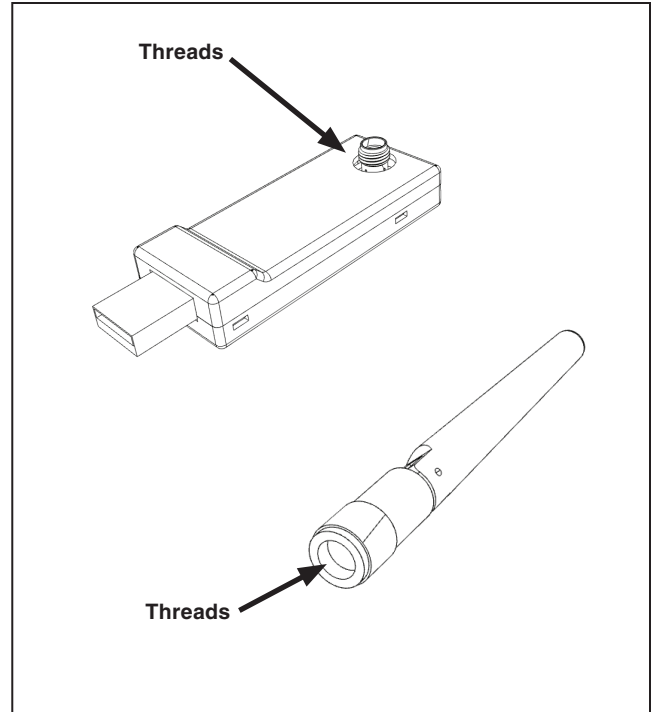

Figure 1. Antenna assembly.

Connecting to a TripSaver II Recloser

STEP 2. Install the USB transceiver. A USB transceiver (firmware version 1.6 or 2.0) must be installed on the computer to communicate with a TripSaver II recloser. (A USB transceiver with firmware version 2.0 is required to communicate with TripSaver II Cutout-Mounted Reclosers with firmware version 2.0 or later.) Insert the USB transceiver into any USB port on the computer. See Figure 2. The installation process is automatic.

Note: The USB transceiver does not need to be installed to install the software on the computer and to run the software in **Standalone (Offline)** mode.

STEP 3. Assemble the power supply and power up the TripSaver II recloser.

A TripSaver II recloser must be powered by the power module to enable its communication capability. Complete the following steps before attempting to communicate with the TripSaver II recloser.

- (a) Plug the pin of the ac adapter into the opening on the power module. See Figure 3.
- (b) Position the power module near the base of the TripSaver II recloser, as shown in Figure 4; the module will be held in place magnetically.

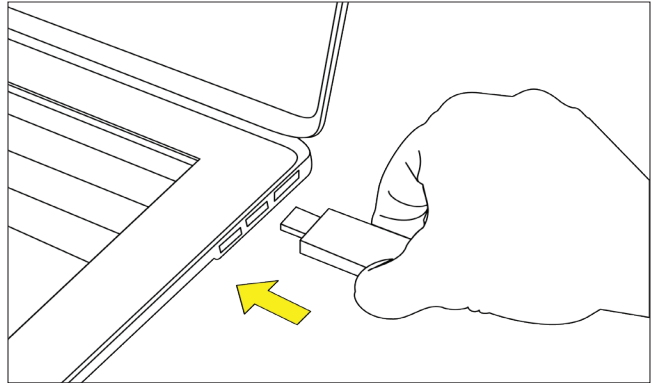

Figure 2. Plug the USB transceiver into the computer.

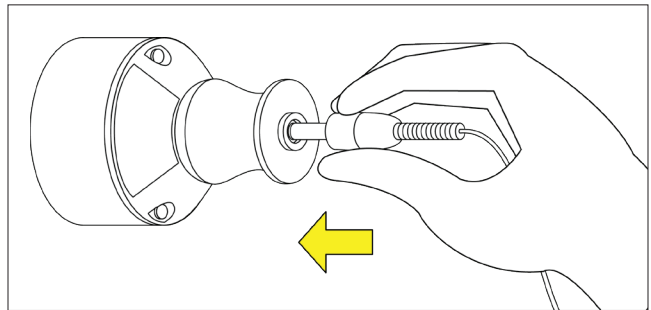

Figure 3. Plug in the ac adapter pin.

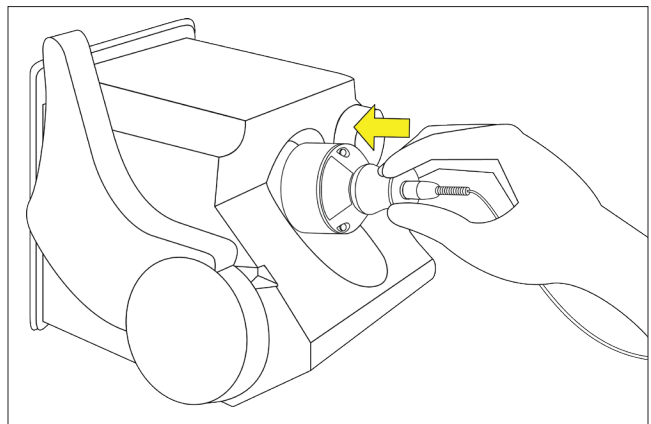

Figure 4. Position the power module.

- (c) Install the proper power outlet plug adapter onto the ac adapter. See Figure 5.
- (d) Plug the ac adapter into a wall outlet. See Figure 6.
- (e) To verify the TripSaver II recloser is powered, rotate the MODE SELECTOR lever and observe the LCD screen. If the LCD screen begins to scroll, it indicates the unit has been successfully powered.

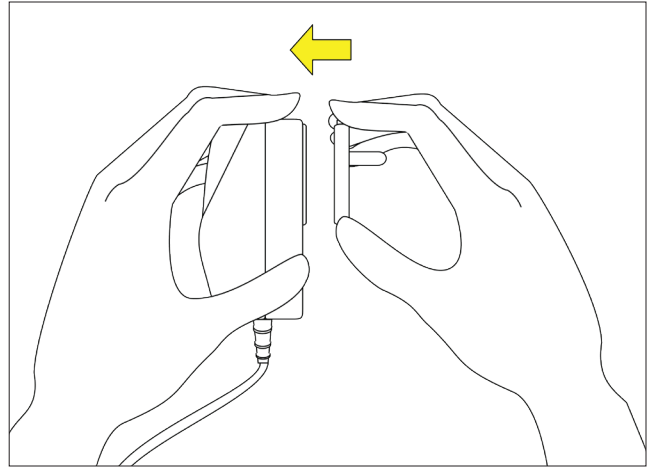

Figure 5. Install the plug adapter.

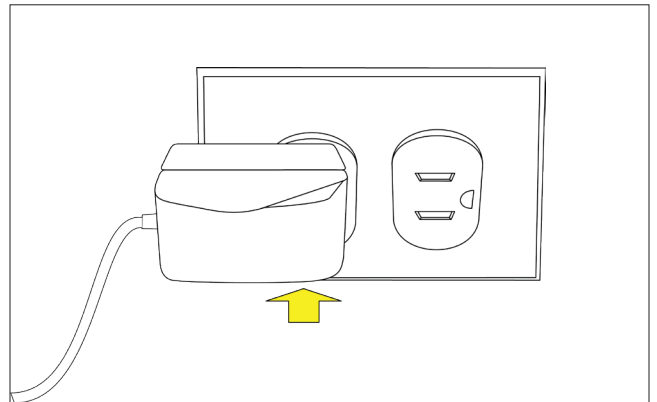

Figure 6. Connect the ac adapter to a wall outlet.

Connecting to a TripSaver II Recloser

After completing Step 3, the setup should look like the picture in Figure 7.



Figure 7. Completed TripSaver II recloser setup.

STEP 4. Obtain the transceiver ID.

A transceiver ID unique to each TripSaver II recloser is needed to establish communications between the computer and the recloser. The ID consists of a 32-digit character string in the format of

“0019C900.00020000. _____”

- (a) **Method 1:** The transceiver ID is embedded in the QR code laser-etched onto the lower housing of each TripSaver II recloser, as shown in Figure 8. Download a free smart phone QR scanner app and scan the QR code to obtain the transceiver ID. Some smart phones have QR code scanners built into their cameras.



Figure 8. The location of the QR code.

- (b) **Method 2:** Rotate the mode selector lever to initiate the display screens after the TripSaver II recloser is powered up. The first screen to appear will contain the transceiver ID. See Figure 9.
- (c) **Method 3:** The transceiver ID is also printed on the back of the yellow “DO NOT DROP—HANDLE WITH CARE” tag attached to each TripSaver II recloser. See Figure 10.

STEP 5. Connect to Device

The TripSaver II Service Center Configuration Software v2.1 will auto-detect the Transceiver ID of TripSaver II reclosers with firmware version 1.8 or later. If connection difficulties are encountered, or when connecting to a TripSaver II recloser with firmware version 1.7 or earlier, enter the Transceiver ID manually. The first 16 digits of the ID are pre-typed; only the last 16 digits must be entered.

Note: When multiple TripSaver II reclosers are powered near one USB transceiver, the Service Center Configuration Software will connect to the first signal received. This may not be the desired recloser. Either disconnect the power to the other nearby reclosers, or connect to the desired recloser by manually entering the Transceiver ID.

- (a) To connect to a TripSaver II recloser, select **Connection>Connect to Device** from the **Main** menu or click on the **Connect to Device** icon  in the quick access toolbar. Make sure the USB transceiver is already plugged into the computer.
- (b) Next, a Transceiver ID Request dialog box will open. Enter the transceiver ID of the TripSaver II recloser being connected to, and click on the **OK** button to connect. The first 16 digits of the ID are pre-typed, so only the last 16 digits must be typed in. See Figure 11.

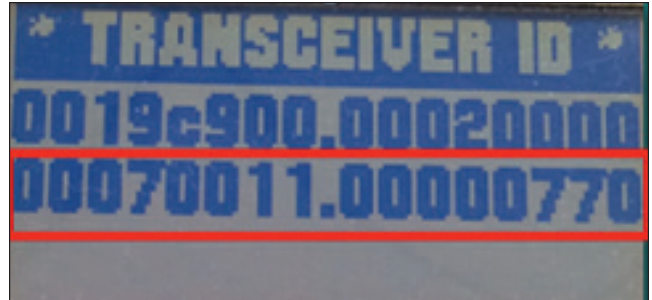

Figure 9. Transceiver ID on the TripSaver II recloser LCD screen.

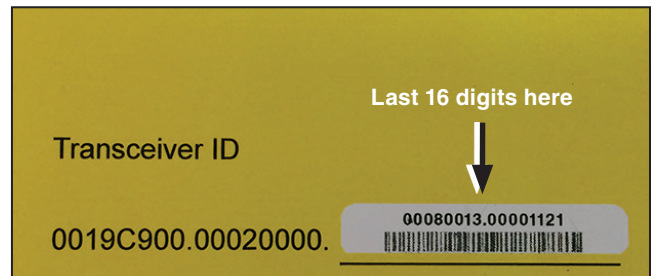

Figure 10. Transceiver ID on yellow tag.

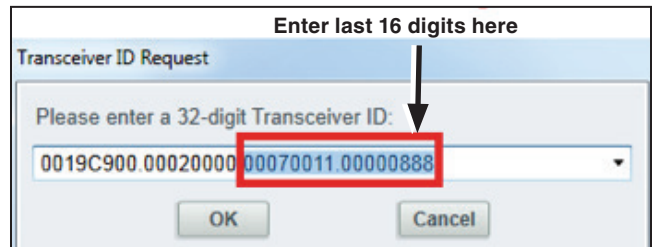

Figure 11. Enter last 16 digits into the Transceiver ID Request dialog box.

Connecting to a TripSaver II Recloser

- (c) During the connection process, a status bar will be displayed. See Figure 12. Wait about 10 seconds for the connection process to finish, or click on the **Cancel** button to cancel the connection process.
- (d) The *Status* screen will appear after the TripSaver II recloser is successfully connected. See Figure 13. Existing settings, status information, and event logs of the TripSaver II recloser can now be viewed, or new settings for the device can be applied.

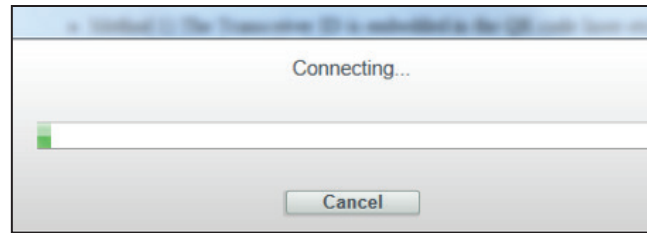

Figure 12. The Connection status bar.

Status

Gateway ON **Current:** 0 A

Interrupter Contacts	Mode	Sectionalizing Mode	Sectionalizing Counts
CLOSED	AUTO	Disabled	
		Battery Charge Level	Battery Status
		99 %	Ok
# of Operations	Remaining Contact Wear	Last Fault Current	Status
0	100 %	0 A	Ok

TCC Curve Summary

Initial Trip	Microprocessor Recloser	Curve: S&C 104	Pick-up Characteristics: 100A - Min Trip
Test 1	Microprocessor Recloser	Curve: S&C 104	Pick-up Characteristics: 100A - Min Trip
Test 2	Microprocessor Recloser	Curve: S&C 133	Pick-up Characteristics: 100A - Min Trip
Test 3	Microprocessor Recloser	Curve: S&C 133	Pick-up Characteristics: 100A - Min Trip

General Device Information

Hardware		Firmware	
Voltage Rating (Max)	29 kV	TripSaver II DSP Application	01.02.32.B4
Continuous Current Rating	100 A	TripSaver II Boot Loader	01.02.32.B4
Interrupting Rating, Symm.	4 kA	TripSaver II Transceiver Application	01.02.32.B4
System Frequency	60 Hz	USB Transceiver Application	01.01.22.A9
Serial Number	TCMR-0097406	Gang Operation Capability	YES
Unit Configured On	03/16/2021 10:26:47.000	Extended Open Interval	YES
Original Catalog Number	990132-CO	Firmware Ver. 1.7 and up	YES

System Information: -61 dBm | Connected To: TCMR-0097406 | Transceiver ID: 0019C900.00020000.00020013.0903118

Figure 13. The Recloser Status screen.

Regulatory and Compliance Statements:

This document contains statements required for compliance with the rules and policies of various national and international regulatory agencies. The information is current as of the date of this publication but may be subject to change without notice. For the most recent version of this instruction sheet with the most up-to-date regulatory information, contact S&C Electric Company.

United States of America – FCC (Federal Communication Commission)

This device complies with part 15 of the FCC rules and regulations regarding unlicensed transmissions. Operation is subject to the following two conditions: (1) This device may not cause harmful interference and (2) this device must accept any interference.

IMPORTANT! Changes or modifications not expressly approved by S&C Electric Company could void the user's authority to operate the equipment.

Note: This equipment has been tested and found to comply with the limits for a Class A digital device, pursuant to part 15 of the FCC Rules. These limits are designed to provide reasonable protection against harmful interference when the equipment is operated in a commercial environment. This equipment generates, uses, and can radiate radio frequency energy and, if not installed and used in accordance with the instruction manual, may cause harmful interference to radio communications. Operation of this equipment in a residential area is likely to cause harmful interference in which case the user will be required to correct the interference at his own expense.

Canada – ISED (Innovation, Science & Economic Development Canada)

This device complies with Industry Canada license-exempt RSS standard(s). Operation is subject to the following two conditions: (1) this device may not cause interference, and (2) this device must accept any interference, including interference that may cause undesired operation of the device.

Cet appareil est conforme aux normes Industry Canada exemptes de licence RSS standard(s). Son fonctionnement est soumis aux deux conditions suivantes: (1) cet appareil ne doit pas provoquer d'interférences et (2) cet appareil doit accepter toute interférence, y compris les interférences susceptibles de provoquer un fonctionnement indésirable.

The changes or modifications not expressly approved by the S&C Electric Company could void the user's authority to operate the equipment.

CAN ICES-3 (A)/NMB-3(A)

Brazil (ANATEL)

Atendimento à Regulamentação Anatel



Este equipamento não tem direito à proteção contra interferência prejudicial e não pode causar interferência em sistemas devidamente autorizados.

Este produto está homologado pela ANATEL, de acordo com os procedimentos regulamentados pela Resolução 242/2000, e atende aos requisitos técnicos aplicados.

Para maiores informações, consulte o site da ANATEL. www.anatel.gov.br

Thailand

This radiocommunication equipment is exempted to possess license, user license, or radiocommunication station license as per NBTC notification regarding radiocommunication equipment and radiocommunication station has been exempted for license according to radio communication act B.E.2498



กสทช.

เครื่องวิทยุคมนาคมนี้ ได้รับยกเว้น ไม่ต้องได้รับใบอนุญาตให้มี ใช้ซึ่งเครื่องวิทยุคมนาคม หรือตั้งสถานีวิทยุคมนาคมตามประกาศ กสทช. เรื่อง เครื่องวิทยุคมนาคม และสถานีวิทยุคมนาคมที่ได้รับยกเว้นไม่ต้องได้รับใบอนุญาตวิทยุคมนาคมตามพระราชบัญญัติวิทยุคมนาคม พ.ศ. 2498



กสทช. | โทรคมนาคม

กำกับดูแลเพื่อประชาชน

Call Center 1200 (InsWi)